

ASTRID J. CLOS
 PLANNING CONSULTANTS
 423 WOOLWICH STREET, SUITE 201
 GUELPH, ONTARIO
 Phone: (519) 836-7526 (836-PLAN)
 Fax: (519) 836-9568
 Cell: (519) 710-7526 (710-PLAN)
 Email: astrid.clos@ajcplanning.ca
 Web: www.ajcplanning.ca

**MAYBERRY HILL PHASE 3
 DRAFT PLAN OF SUBDIVISION
 22T-201501**

DATE: DECEMBER 22, 2017 DRAWN BY: G.K.S.
 PROJECT No.: 1401 SCALE: 1:1,500

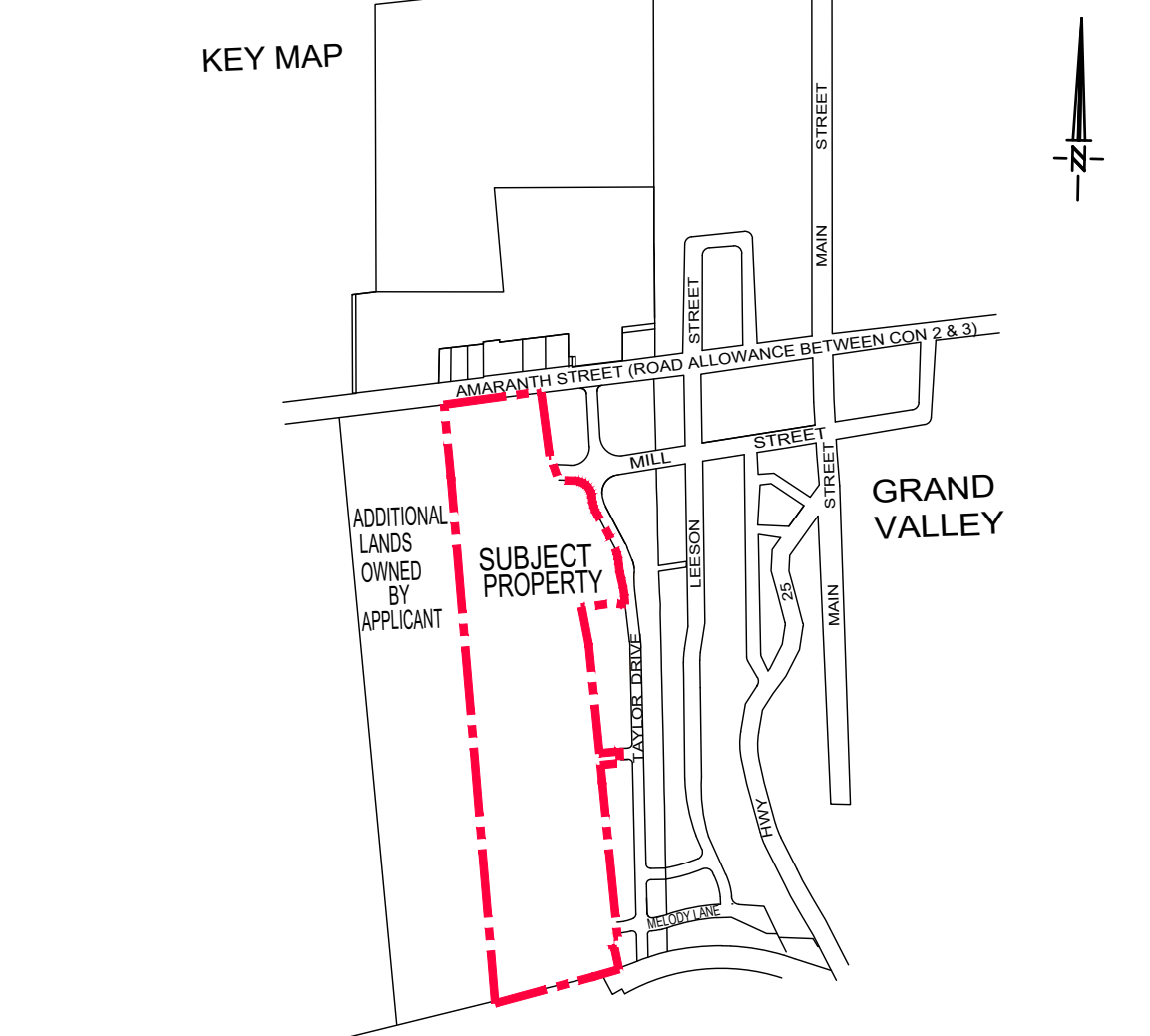

LEGAL DESCRIPTION
 Part of Lot 30, Concession 2
 (Geographic Township of East Luthy)
 (Formerly Village of Grand Valley)
 All of Blocks 107, 108, 109, 110, 111, 112, 113, 114, 117 and 118
 Registered Plan 7M-53
 Town of Grand Valley
 County of Dufferin

LAND USE SCHEDULE

DESCRIPTION	LOTS/BLOCKS	UNITS	AREA (hectares)
SINGLE DETACHED LOTS			
13.72m (45')	32-44, 69, 110, 112, 129, 139-145, 176, 197, 199, 204-213, 215, 263-273, 275	50	11.18
12.2m (40')	25-27, 45-56, 64-70, 75-87, 90, 91, 97-108, 114-127, 130, 133-138, 146, 148, 150, 153-164, 170-172, 182-195, 216, 219-232, 236, 237, 253-255, 259, 262, 274	125	
11m (36')	1-24, 28-31, 57-63, 71-74, 88, 92-96, 109, 131-132, 147-148, 151, 152, 165-169, 173-175, 196, 177-181, 198, 200-203, 214, 217, 218, 233-235, 236-252, 256-258, 260, 261	100	
TOWNHOUSES	276, 277	108	3.31
OPEN SPACE	278	-	1.11
STORMWATER MANAGEMENT	279	-	1.81
FUTURE DEVELOPMENT	280, 281	-	0.08
ROAD WIDENING	282	-	0.04
ROADS	-	-	6.01
TOTAL		383	23.54

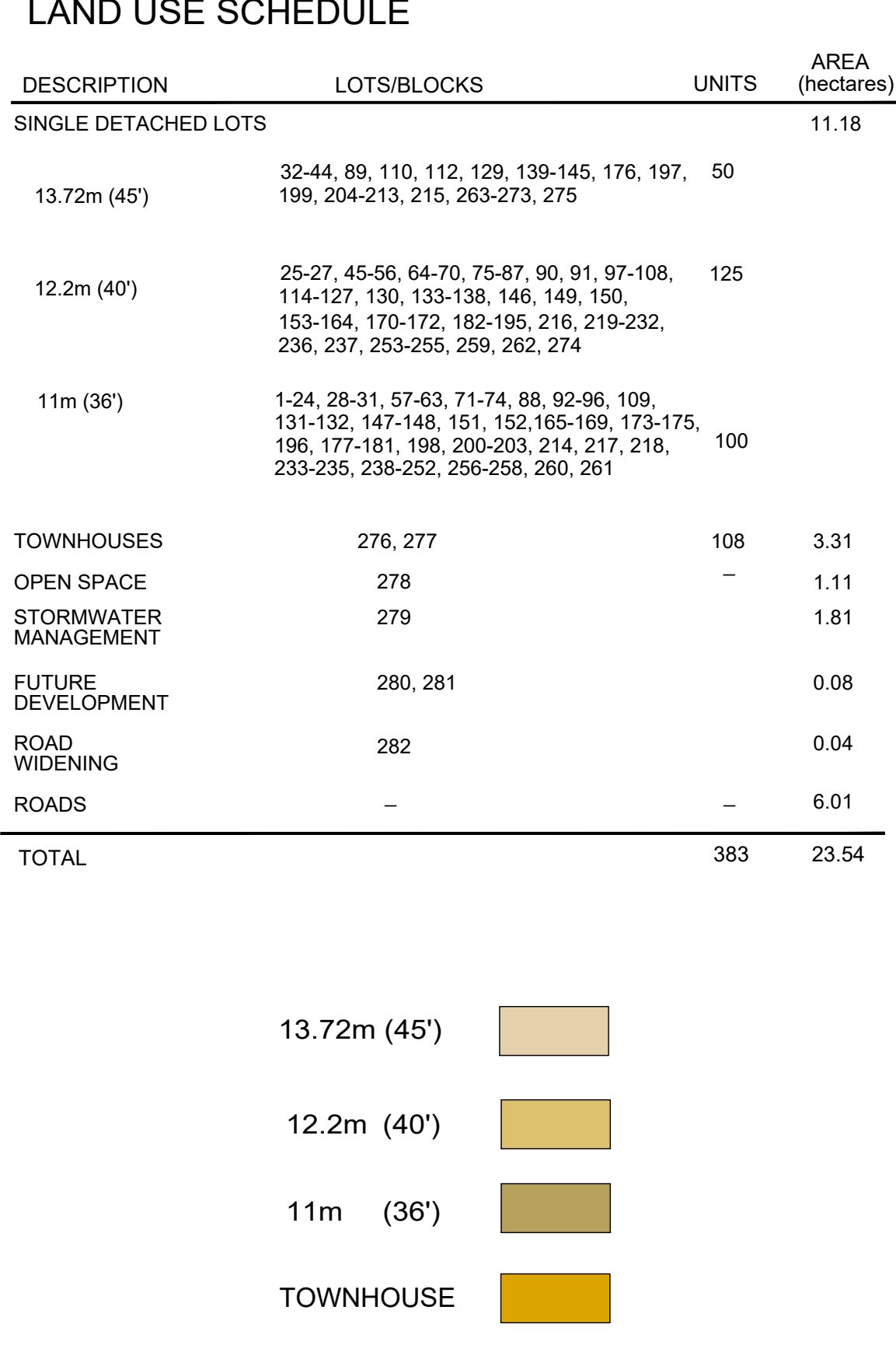

NOTES:
 INFORMATION REQUIRED BY CLAUSES a,b,c,d,e,f,g) AND I ARE AS SHOWN ON DRAFT PLAN.
 h) municipal water supply
 i) all loam and loam III soils
 j) municipal sanitary and storm sewers

CORNER LOTS
 Single Detached Residential
 45' (13.72m) = 17.02m
 40' (12.2m) = 15.5m
 36' (11m) = 14.3m

ADDITIONAL INFORMATION
 (UNDER SECTION 51(17) OF THE PLANNING ACT)
 INFORMATION REQUIRED BY CLAUSES a,b,c,d,e,f,g) AND I ARE AS SHOWN ON DRAFT PLAN.
 h) municipal water supply
 i) all loam and loam III soils
 j) municipal sanitary and storm sewers

OWNER'S CERTIFICATE
 I AUTHORIZE ASTRID J. CLOS PLANNING CONSULTANTS LIMITED TO PREPARE AND SUBMIT THIS DRAFT PLAN OF SUBDIVISION.

Tom Krizan
 TOM KRIZAN
 THOMASFIELD HOMES LIMITED

JULY 21, 2015
 DATE

SURVEYOR'S CERTIFICATE
 I CERTIFY THAT THE BOUNDARIES OF THE LAND TO BE SUBDIVIDED AND THEIR RELATIONSHIP TO THE ADJACENT LANDS ARE CORRECTLY SHOWN.

John Scott
 JOHN SCOTT
 VAN HARTEN SURVEYING INC.

JULY 21, 2015
 DATE